

## Information Sheet 2

### MICROFENCE EDGE GUIDE

- 1 Leadscrew adjusting Knob
- 2 Brass Locking Thumbscrews (Long) for approximate positioning
- 3 Brass Locking Thumbscrew (Short) for Spindle Locking
- 4 Stainless Steel Lead Screw/Spindle
- 5 Laser-Etched Micrometer Dial
- 6 Spindle Bar
- 7 Main Body
- 8 Mounting Bar (Interchangeable to fit other routers)
- 9 Stainless Steel Guide Shafts
- 10 Mounting Pins (Vary according to router model)

- 11a 8-32 Tapped holes (To attach wood fence or half-rounds)
- 12 Press fit bushings
- 13 Thrust Washer
- 14 Thrust Washer
- 15 Metal Wave Washer
- 16 Lock Nut

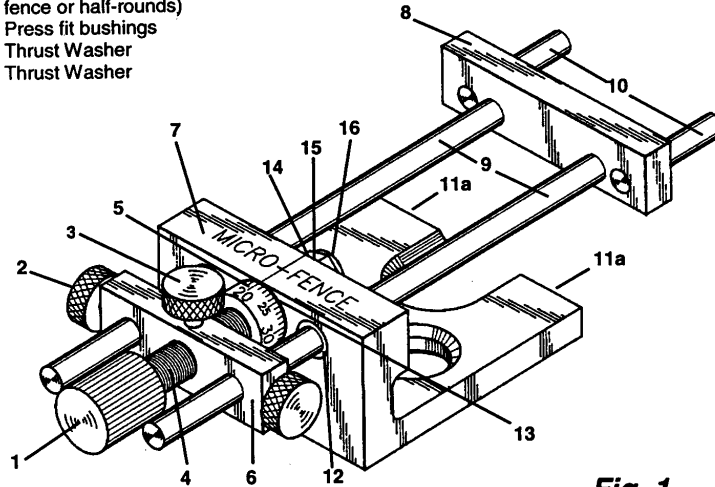

**Fig. 1**

**Fig. 2**

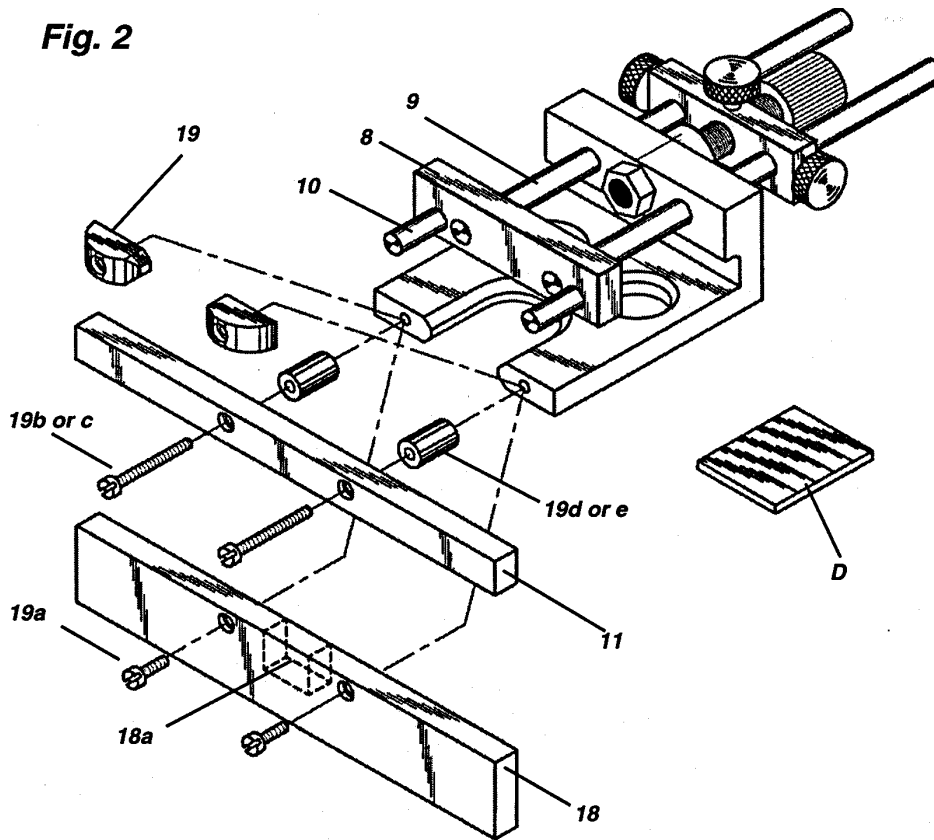

- 8 Mounting Bar
- 9 Stainless Steel Guide Shafts
- 10 Mounting Pins
- 11 Low Profile Wood Fence
- 18 Deep Profile Wood Fence
- 18a Notch for bit pass through
- 19 Half-round inserts
- 19a 8-32 x 1/2" Fillister Screw
- 19b 8-32 x 1 1/4" Fillister Screw
- 19c 8-32 x 1 3/4" Fillister Screw
- 19d 5/8" Delrin Spacers
- 19e 1 1/4" Delrin Spacers
- D Rubber Pad

## ATTACHING THE MICRO FENCE TO YOUR ROUTER

The Micro Fence you ordered includes the appropriate mounting bar, pins and screws to fit the router you have specified. Once you have removed the fence from its packaging and checked all parts for tightness, simply slide the mounting pins into the existing holes in your router's base and install the screws we supply to lock the fence onto the router. (If your router already has the necessary locking screws, keep the set supplied with your Micro Fence for backup.)

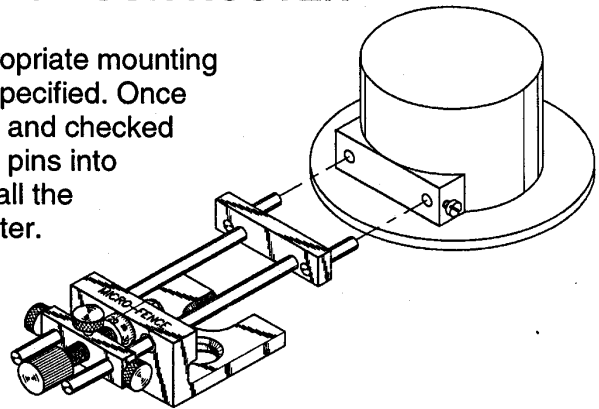

### Operations:

#### **I. Dadoes:**

To cut any size dado, use the technique described in Example B on page 6. Make an initial cut with a bit smaller than the thickness of the stock you're working with, measure the first cut, then take a second pass after adjusting the fence to widen the first cut by the desired amount. Dadoes of virtually any width can be accomplished with this two-cut method.

- a. Parallel Dadoes: Fitting your Micro Fence with the Circle Jig Attachment allows you to rout any number of straight, parallel dadoes. First, attach the aluminum fence supplied with the Circle Jig to the bottom of either trammel bar. The aluminum fence is designed to reach down into the last cut you made, allowing you to make repetitive dadoes at equal spacing, (or at any spacing you choose).

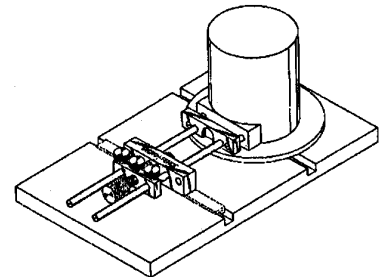

**II. Rabbeting:** Rabbet cuts can be accomplished with the same two-cut approach used for dadoes. Notching the deep profile wooden fence, (Fig.2, #18a), will let you use any portion of your router bit. Measure your first cut with the back end of your dial calipers and then dial the appropriate adjustment for any dimension you require.

Information 2, con't.

MICROFENCE EDGE GUIDE ACCESSORIES

**“Tru-Grip Clamp” Interface:** By fitting this accessory to our Circle Jig, the Micro Fence will slide along the extrusion of a “Tru-Grip Pro Ft'r” clamp. This guides the router in a straight line, for dadoes, grooves or decorative cuts across any flat surface.

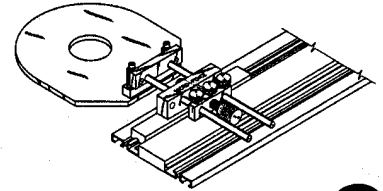

The **Circle Jig Attachment (CJA):** Our Circle Jig Attachment can be mounted on the guide shafts (Fig.1, #9) in place of the edge guide for circular cutting requirements. The standard attachment allows you to rout circles and arcs from 6 in. to 48 in. in diameter. Longer rods (24” or 36”) are available for larger diameter work.

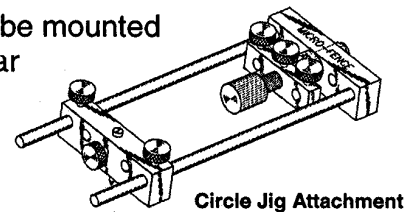

**Vacuum Center Accessory (VCA):** This accessory eliminates the need to drill a pilot hole to secure the center pivot when routing circles. Your air compressor provides the vacuum necessary to hold the center in place. Developed initially for the solid surface and formica trades, the VCA can provide efficient set-ups and unblemished work surface on any cabinet-grade material including plywoods and surfaced lumber.

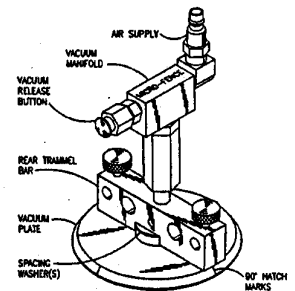

**Reading Calipers:**

This example reads .818”. Read the inch and/or 1/10 inch from the scale on the beam (.800”). Read the 1/100 and 1/1000 inch from the dial (.018”).

To set zero: Wipe the lower jaw faces clean and loosen the bezel locking screw (under the Dial). Close the two lower jaws and rotate the bezel until the needle points to zero. Re-tighten the bezel lock to secure the bezel ring in its new position.

Your calipers will measure inside, outside, depth and offset dimensions. It can also be used as a gauge by setting the beam locking screw at whatever dimension you wish to test.

